

Interface Technology · Microcompact frequency/analogue converter

Input: Frequency AC und DC Signals, 0–28.8 kHz

Output: 0–10 V / 0–20 mA / 4–20 mA, adjustable

Insulation: 4 kV, 3-way isolation



Dimensions

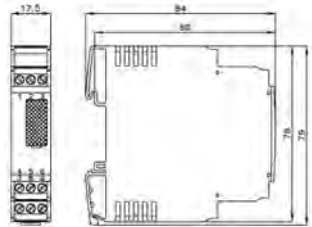

PIN assignment

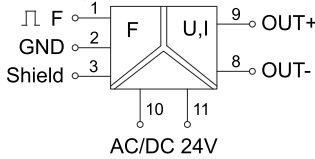

Range adjustment

S2 → Switch On		Range*	
Range*	1 2 3 4 5 6 8	Range*	1 2 3 4 5 6
0–100Hz	●●●●●●	0–5kHz	●●●●●●
0–200Hz	●●●●●●	0–6kHz	●●●●●●
0–250Hz	●●●●●●	0–8kHz	●●●●●●
0–400Hz	●●●●●●	0–10kHz	●●●●●●
0–500Hz	●●●●●●	0–12kHz	●●●●●●
0–750Hz	●●●●●●	0–16kHz	●●●●●●
0–1kHz	●●●●●●	0–20kHz	●●●●●●
0–1.5kHz	●●●●●●	0–24kHz	●●●●●●
0–2kHz	●●●●●●	0–28.8kHz	●●●●●●
0–2.5kHz	●●●●●●		
0–3kHz	●●●●●●		
0–4kHz	●●●●●●		
Hysteresis	0.5Vpp		
	5Vpp		

*see instruction leaflet

● → Switch On		S1
Output	1 2 3	
0–10V	●	
0–20mA	●	
4–20mA	●	

Description	Part-No.	Type	PU	
Screw terminal				
Nominal voltage	AC/DC 24 V	750524	WNFA 6-0524	1
Spring terminal				
Nominal voltage	AC/DC 24 V	751524	WNFA 6-1524	1

Input	0–28.8 kHz			
Input signal	0–100, 0–200, 0–250, 0–400, 0–500, 0–750 Hz 0–1, 0–1.5, 0–2, 0–2.5, 0–3, 0–4, 0–5, 0–6, 0–8 kHz 0–10, 0–12, 0–16, 0–20, 0–24, 0–28.8 kHz adjustable via switch			
Galvanic isolation I/O	3-way isolation			
Frequency signal	AC/DC 0.8–30 V			
Input characteristic impedance	50 kΩ			
Hysteresis	0.5 V _{ss} / 5 V _{ss} , can be converted via switch			
Hysteresis	–			
Pulse width	min. 10 μs			
Output	0/10 V	0–20 mA	4–20 mA	
Max. load impedance at I-output	–	400 Ω	–	
Max. load impedance at U-output	>1 kΩ	–	–	
Load impedance	55	–	–	
Output current	max. 21 mA	–	–	
Output signal	Adjustable via switch			
Output voltage	–			
Ripple	<5 mV _{eff}			
General				
Nominal voltage	AC/DC 24 V			
Operation voltage range	DC: 16.8–30 V, AC: 19.2–28.8 V			
Rated current	20.0 mA	12.0 mA	–	
Status Indication	LED yellow			
Input/output protection	AC/DC 30 V overvoltage, short circuit-proof output			
Accuracy	0.1 % FSR (23 °C)			
Linearity error	0.02 %			
Ripple	approx. 0.1%, range 2...28.8 kHz from 200 Hz			
Build-up time (Accuracy 1%)	200 ms			
Transmission frequency	–			
Temperature coefficient	70 ppm / K			
Insulation voltage input/output	2.5 kV _{eff}	4.0 kV _{eff}	–	
Housing material	PPE			
Field installation	rail TS 35 (EN 50022)			
Protection class	IP 20			
Installation position	Optional			
Termination	screw terminal: 0.14–1.5 mm ²		Spring terminal 0.14–1.5 mm ²	
Operation temperature range	–25 °C – 60 °C			
Storage temperature range	–40 °C – 85 °C			
Dimensions (w × h × d)	17.5 × 79.0 × 84.0 mm			
Weight (kg/piece)	0.070			
Approvals	–			
Accessories	Colour	Article number	Type	PU
Tag holder 7×20 mm	white	760968	BZT-0720	100
Laser printer label 6.35×15.24 mm (sheet with 528 labels)		681033	LEB-0615	1